

FOR LEASE

19,800 SQUARE FEET MANUFACTURING/R&D SPACE



2320 TECHNOLOGY PARKWAY, HOLLISTER, CA

PROPERTY INFORMATION

- Approximately 2/3 Tile-HVAC Manufacturing Assembly Areas
- 2 Grade Level Rollups - 10' x 15'
- 2,000 Amps / 208 Volts / 3 Phase Power
- Lots of Distributed & Dropped Power Lines
- Fully Sprinklered
- 2.6/1,000 Parking
- Available Now - Call to Tour
- \$0.60 PSF, Per Month



Contact Exclusive Agents:

Mark Sanchez
408.842.7000
msanchez@colliersparrish.com

Jeff Barnes
408.842.7000
jbarnes@colliersparrish.com

8070 Santa Teresa Boulevard, Suite 220
Gilroy, CA 95020
408.842.7000 | 408.842.1141 Fax
www.colliersparrish.com

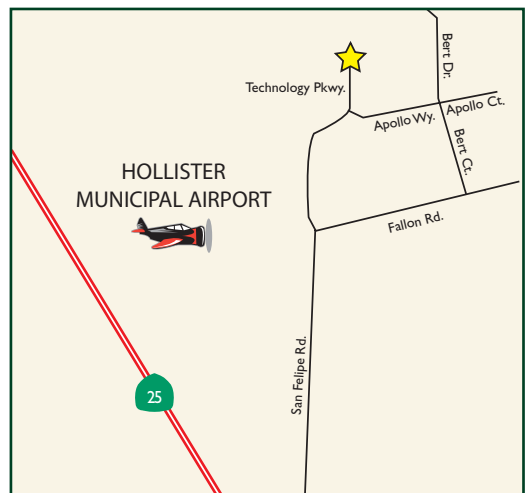

COLLIERS
INTERNATIONAL

FOR LEASE

2320 TECHNOLOGY PARKWAY, HOLLISTER, CA

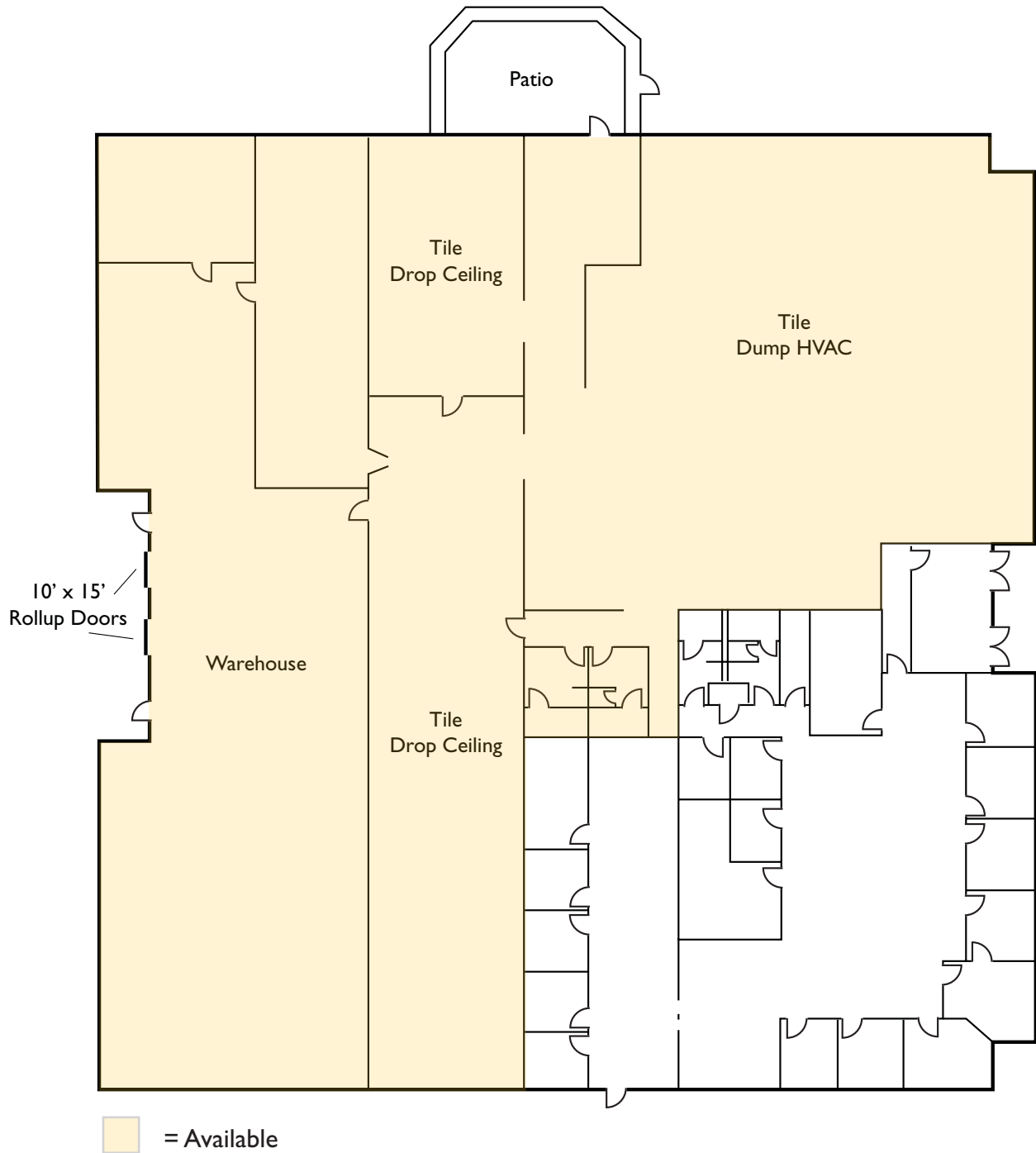

Drawing not exact/
Not to scale

COLLIERS
INTERNATIONAL

Contact Exclusive Agents:

Mark Sanchez

408.842.7000

msanchez@colliersparrish.com

Jeff Barnes

408.842.7000

jbarnes@colliersparrish.com

The information furnished has been obtained from sources we deem reliable and is submitted subject to errors, omissions and changes. Although Colliers International has no reason to doubt its accuracy, we do not guarantee it. All information should be verified by the recipient prior to lease, purchase, exchange, or execution of legal documents. © 2007 Colliers International